

ANTENNA WITH COVER

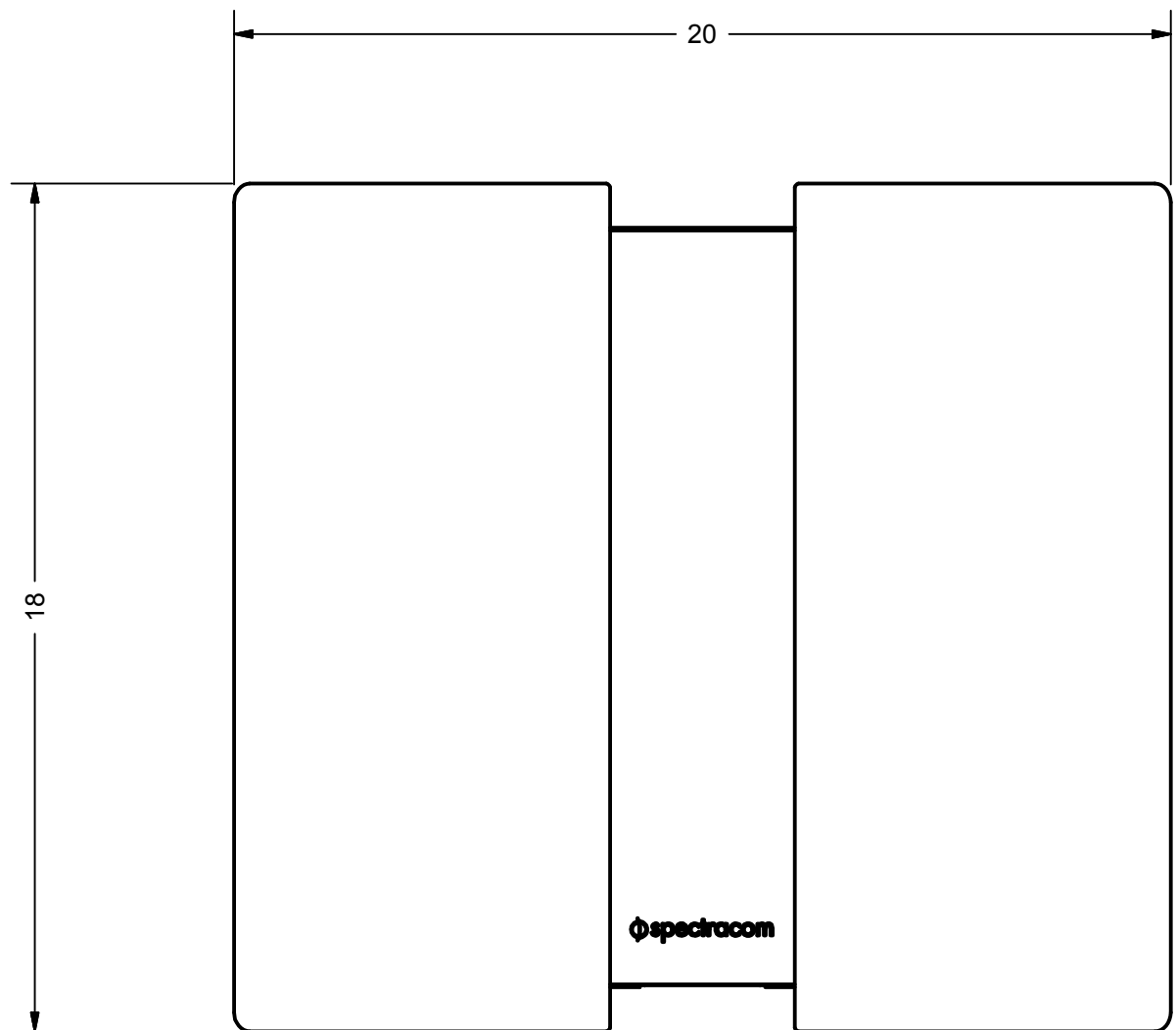

MOUNTING POINTS FOR ATTACHING ANTENNA TO WALL OR OTHER SUITABLE SURFACE.

ANTENNA ONLY

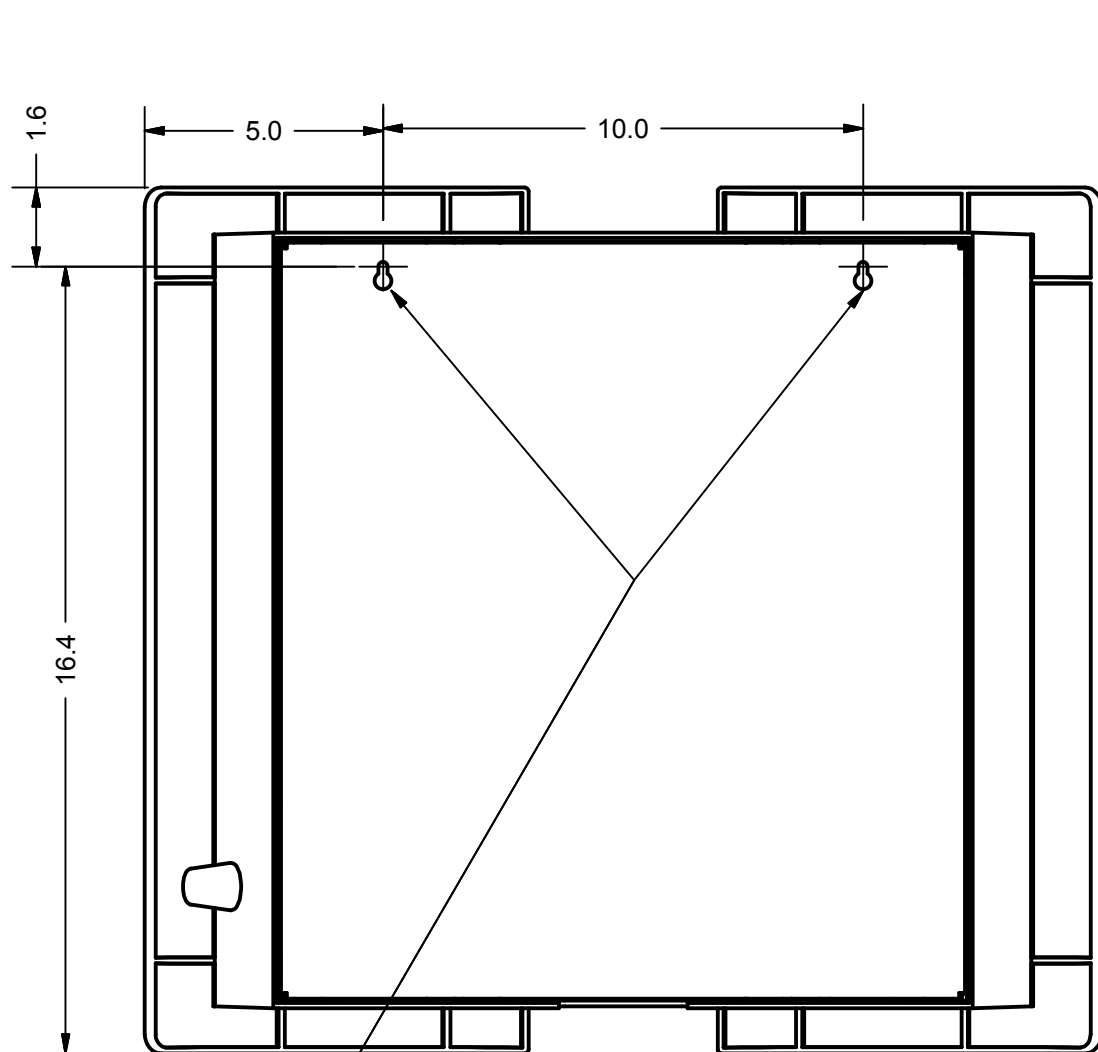
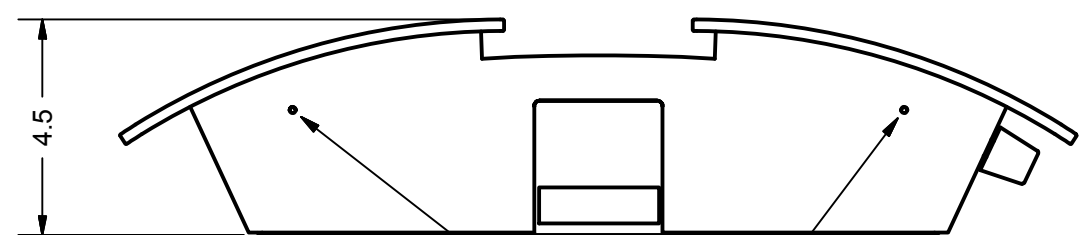
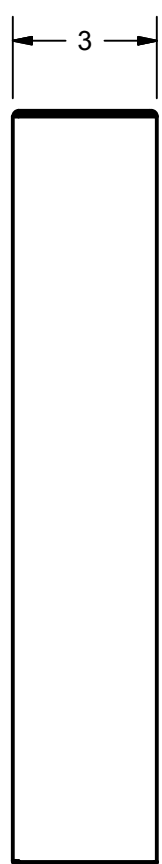
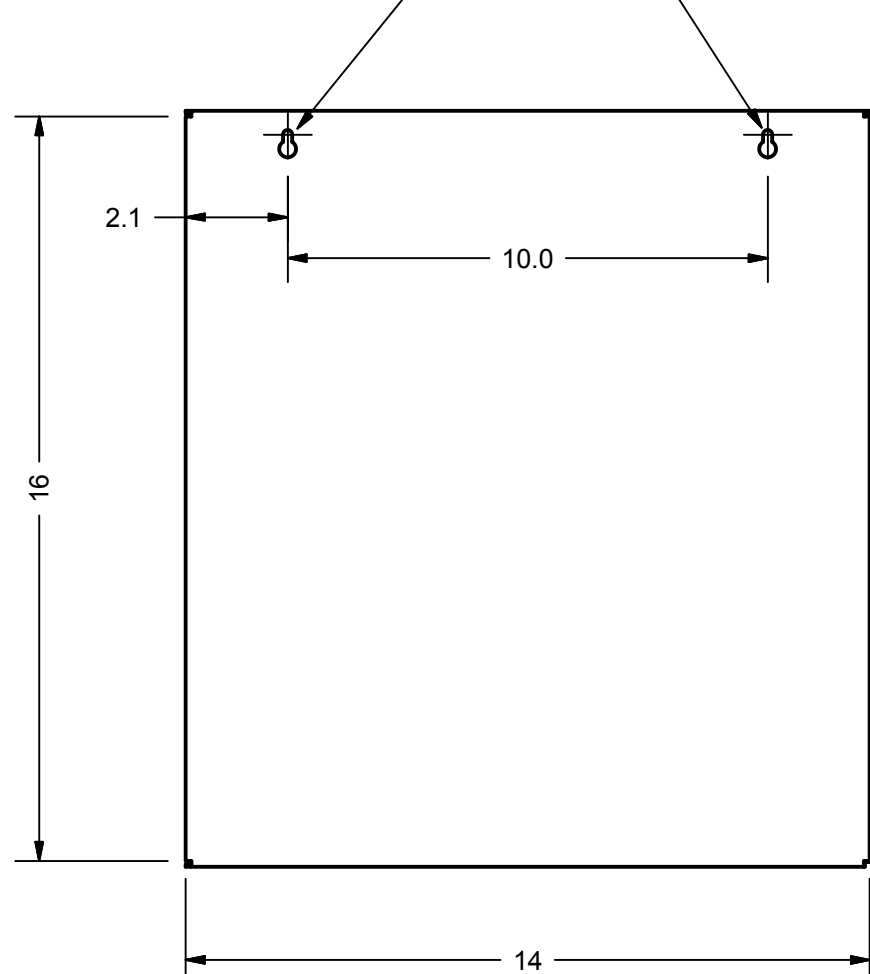

#4 SCREWS (4X) HERE AND OPPOSITE SIDE ATTACH COVER TO ANTENNA AFTER MOUNTING ANTENNA.

Material:	UNLESS OTHERWISE SPECIFIED	Drawn:	S. Holmes	7/11/2013	Title: Skylight Antenna Mounting and Outline		
	DIMENSIONS IN INCHES. X ± 0.020 XXX ± 0.005 XX ± 0.015 ANG. ± 0.5°	Checked:					
Finish:	REMOVE ALL BURRS AND BREAK SHARP EDGES TO .010-.020.	Approvals			 1565 Jefferson Rd., Suite 460 Rochester, New York 14623 TEL: (585) 321-5800 FAX: (585) 321-5219 www.spectracom.oria.com		
	BEND RADII .060" MAX.						
Copyright © 2013 Orolia USA, Inc. All Rights Reserved	THIRD ANGLE PROJECTION	NOTICE THIS DOCUMENT AND DATA DISCLOSED HEREIN OR HERWITH ARE NOT TO BE REPRODUCED, USED, OR DISCLOSED IN WHOLE OR IN PART TO ANYONE WITHOUT THE WRITTEN PERMISSION OF OROLIA USA, INC.			Sheet Size	Dwg. No:	Rev.
					C	1213-1000-0790	1
DO NOT SCALE DRAWING		Scale:			Sheet 1 of 1		